

WATSON

INDUSTRIAL PARK CHINO

505,735 SF

Available For Lease



36' Clear Height for up to 25% more storage space



Build Green. Everyone Profits.

LEED- Leadership in Energy & Environmental Design

Legacy BuildingSM 839 has been constructed as a LEED[®] certified building. LEED[®] developments are voluntary and are designed to be environmentally responsible, high performing, sustainable and healthy places to work.

*LEED is a registered trademark of the U.S. Green Building Council.

Legacy BuildingSM 839

15097 Van Vliet Avenue, Chino, CA

SPECIFICATIONS

BUILDING SIZE: 505,735 SF

OFFICE SIZE: 10,733 SF (includes 5,265 SF finished mezzanine)

LAND SIZE: 1,112,204 SF

TRUCK POSITIONS: Dock high: 104 (9' x 10')
Ground level ramp: 2 (12' x 14')

TRUCK TURNING RADIUS: 190'
Cross-dock loading

MINIMUM CLEARANCE: 36'

SPRINKLER SYSTEM: ESFR (K 25.2 heads)

TRAILER STORAGE SPACES: 141

POTENTIAL POWER CAPACITY: 3,000 amps,
277/480 volts, 3 phase, 4 wire

WAREHOUSE LIGHTING: LED with motion sensors

PARKING SPACES: 204

LEGACY FEATURES

6 1/2" thick, reinforced,
100% concrete truck courts

3% skylights

Architectural two-story glass entries

8" thick, reinforced, 4,000 psi
concrete floor slabs

Abundant clerestory glass



WATSON

INDUSTRIAL PARK CHINO

505,735 SF

Available For Lease



OFFICE PLAN 10,733 Total SF

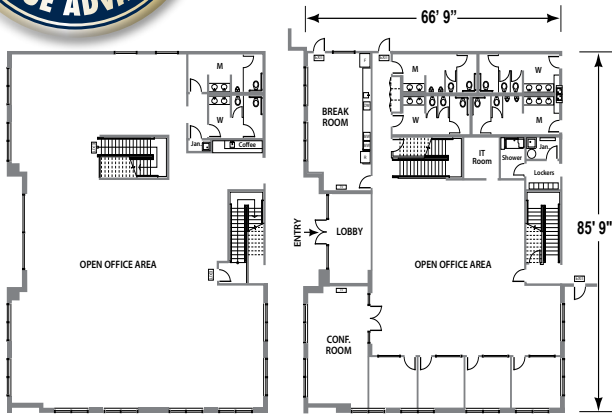

Mezzanine 5,265 SF

First Floor 5,468 SF

WATSON INDUSTRIAL PARK CHINO

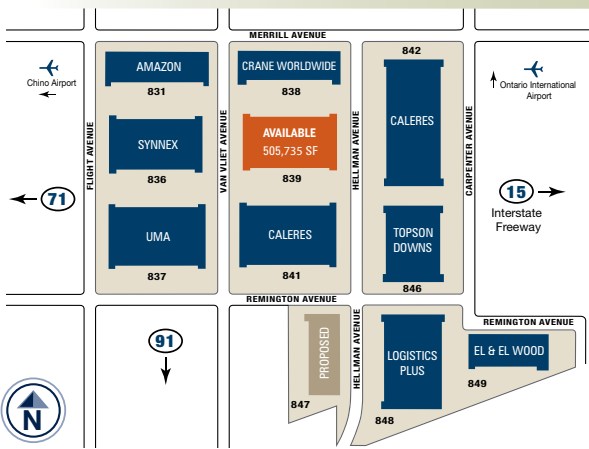

LEGACY BUILDINGSM 839 SITE PLAN

LEED[®] Certified

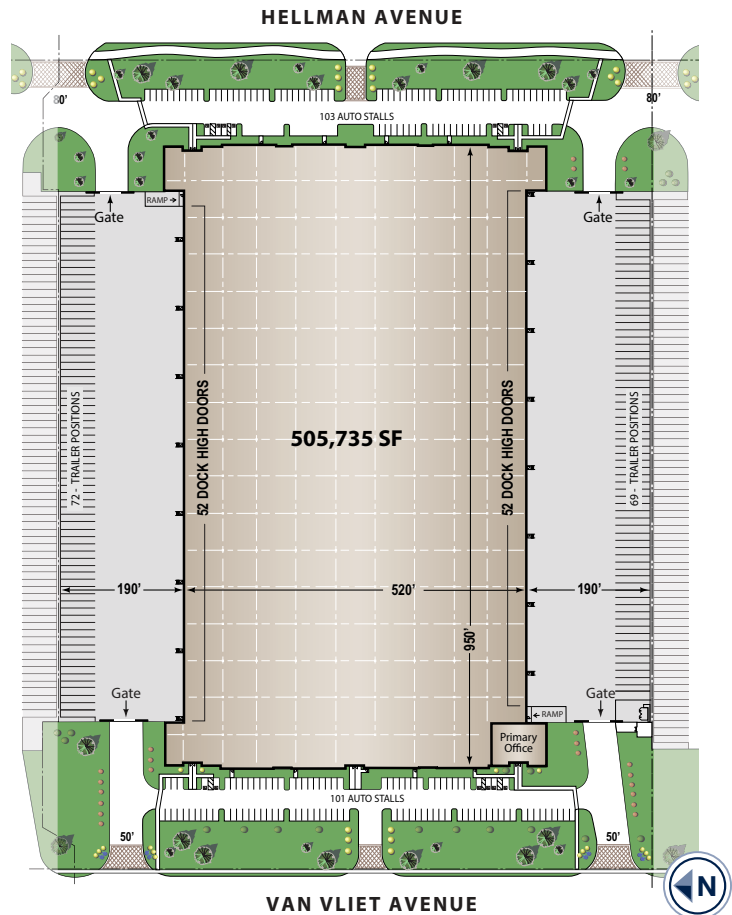

Thomas E. Taylor

thomas.taylor@colliers.com
License # 00598896

Steven J. Bellitti

steve.bellitti@colliers.com
License # 01048797

Joey Jones

joey.jones@colliers.com
License # 01952925

Evelyn Manning

evelyn.manningi@colliers.com
License # 02052838

Ph 909.605.9400 Fax 909.396.4300



Our Knowledge is your Property

COLLIERS International

2855 E. Guasti Road
Suite 401

Ontario, CA 91761

colliers.com



The information on this brochure has been compiled for the internal administrative convenience of Watson Land Company. Watson Land Company makes no representation or warranty, express or implied, as to the accuracy of this brochure. This brochure may not reflect all building improvements or as-built conditions. The information contained herein and on any other materials with which it is presented is not an offer and is subject to change without notice. Tenants should make their own independent investigations of all facts and assumptions on which they might rely in making a decision to lease property from Watson Land Company.

Developed Owned and Managed by WATSON LAND COMPANY 22010 Wilmington Avenue, Carson, California 90745

Phone 310.952.6417