

# WATSON

INDUSTRIAL PARK CHINO

## 505,735 SF

Available For Lease

Cross Dock-Loading

**36'** Clear Height *for up to 25% more storage space*



Build Green. Everyone Profits.

### LEED- Leadership in Energy & Environmental Design

Legacy Building<sup>SM</sup> 839 has been constructed as a LEED<sup>®</sup> certified building. LEED<sup>®</sup> developments are voluntary and are designed to be environmentally responsible, high performing, sustainable and healthy places to work.

\*LEED is a registered trademark of the U.S. Green Building Council.

Legacy Building<sup>SM</sup> **839**

15097 Van Vliet Avenue, Chino, CA

### SPECIFICATIONS

**BUILDING SIZE:** 505,735 SF

**OFFICE SIZE:** 10,733 SF (includes 5,265 SF finished mezzanine)

**LAND SIZE:** 1,112,204 SF

**TRUCK POSITIONS:** Dock high: 93 (9' x 10')  
Ground level ramp: 2 (12' x 14')  
Fifty (50) 30,000 lb capacity edge of dock levelers  
Fifty Four (54) 30,000 lb mechanical pit mounted dock levelers

**BATTERY CHARGING STATIONS:** 10

**TRUCK TURNING RADIUS:** 190'  
Cross-dock loading

**MINIMUM CLEARANCE:** 36'

**SPRINKLER SYSTEM:** ESFR (K 25.2 heads)

**TRAILER STORAGE SPACES:** 141

**POTENTIAL POWER CAPACITY:** 3,000 amps,  
277/480 volts, 3 phase, 4 wire

**HVLS FANS:** 4

**WAREHOUSE LIGHTING:** LED with motion sensors

**PARKING SPACES:** 204

### LEGACY FEATURES

6 1/2" thick, reinforced,  
100% concrete truck courts

3% skylights

Architectural two-story glass entries

8" thick, reinforced, 4,000 psi  
concrete floor slabs

Abundant clerestory glass



# WATSON

INDUSTRIAL PARK CHINO

# 505,735 SF

Available For Lease



## OFFICE PLAN 10,733 Total SF

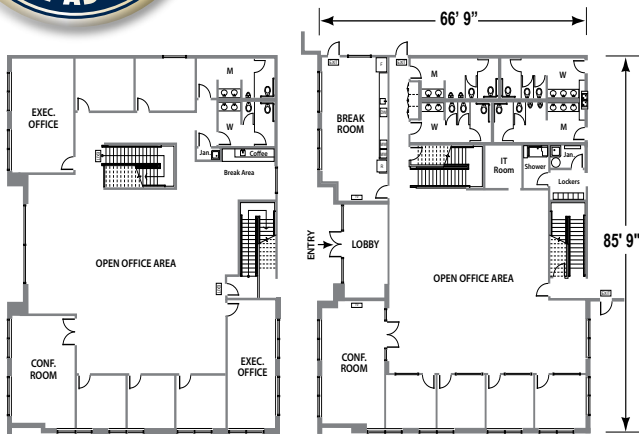

Mezzanine 5,265 SF

First Floor 5,468 SF

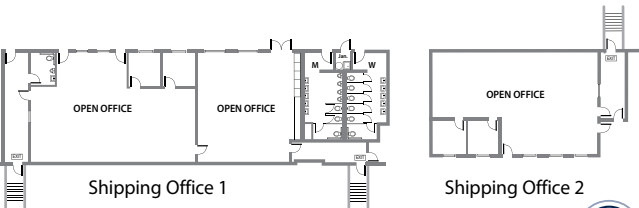

Shipping Office 1

Shipping Office 2



## LEGACY BUILDING<sup>SM</sup> 839 SITE PLAN

LEED<sup>®</sup> Certified

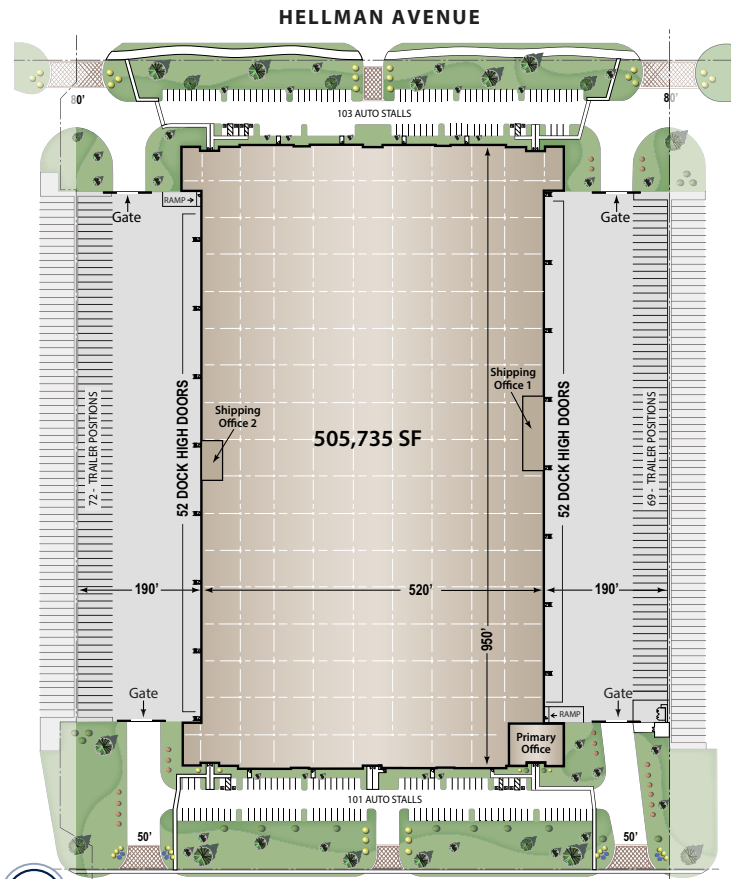

## WATSON INDUSTRIAL PARK CHINO



**Thomas E. Taylor**  
thomas.taylor@colliers.com  
License # 00598896

**Steven J. Bellitti**  
steve.bellitti@colliers.com  
License # 01048797

**Joey Jones**  
joey.jones@colliers.com  
License # 01952925

**Evelyn Manning**  
evelyn.manningi@colliers.com  
License # 02052838

Ph 909.605.9400 Fax 909.396.4300



Our Knowledge is your Property

**COLLIERS International**  
2855 E. Guasti Road  
Suite 401  
Ontario, CA 91761  
colliers.com

The information on this brochure has been compiled for the internal administrative convenience of Watson Land Company. Watson Land Company makes no representation or warranty, express or implied, as to the accuracy of this brochure. This brochure may not reflect all building improvements or as-built conditions. The information contained herein and on any other materials with which it is presented is not an offer and is subject to change without notice. Tenants should make their own independent investigations of all facts and assumptions on which they might rely in making a decision to lease property from Watson Land Company.